

# ***Shark***<sup>®</sup>

## **ROTATOR**<sup>™</sup>

OWNER'S GUIDE

NV750ANZ



Thank you for purchasing the Shark® Rotator™ Professional Powered Lift Away™ Upright Vacuum.

This Owner's Guide is designed to help you get a complete understanding of your new vacuum cleaner. Please read it carefully and keep it for future reference.

For a list of what is included with this model, refer to inside flap of box.

If you should have a question about your Shark® Rotator™, please call AUST: 1800 890 840 or NZ: 0800 002 999.

THANK YOU!

REGISTER YOUR PURCHASE:

☎ AUST: 1800 890 840

☎ NZ: 0800 002 999

RECORD THIS INFORMATION:

Model Number: \_\_\_\_\_

Date of Purchase (Keep receipt): \_\_\_\_\_

TECHNICAL SPECIFICATIONS:

Voltage: 220-240V~, 50/60Hz  
Main Body Motor Watts: 1100W  
Power Nozzle Watts: 80W  
Motorized Brush Watts: 30W

RECOMMENDED FILTER CLEANING SCHEDULE:

See the MAINTENANCE section for filter cleaning instructions

Foam filter:	<b>XFF650</b>	Every 3 months
Felt Filter:	<b>XFF650</b>	Every 3 months
HEPA Filter:	<b>XHF650</b>	Every 12 months



GMA-102233-EA-009



AUST: 1800 890 840

IMPORTANT SAFEGUARDS

When using an electrical appliance, basic safety precautions should always be observed, including the following:



WARNING

This appliance is not intended for use by persons with reduced physical, sensory or mental capabilities, or lack of experience and knowledge, unless they have been given supervision or instruction concerning use of the appliance by a person responsible for their safety.

Children shall not use or play with this appliance. Close supervision is necessary to keep appliance out of reach of children during use.



CAUTION

THE POWER NOZZLE, WAND, HOSE, MOTORIZED BRUSH AND HANDLE CONTAIN ELECTRICAL CONNECTIONS:

- These are not serviceable parts.
- Do not use to vacuum any liquids.
- Do not immerse in water when cleaning.
- Prior to use, inspect hose for damage. Discontinue using if damaged.



WARNING

TO REDUCE THE RISK OF FIRE, ELECTRIC SHOCK OR INJURY:

- 1 DO NOT use outdoors or on wet surfaces.
- 2 Unplug from electrical outlet when not in use and before cleaning or servicing.
- 3 DO NOT use with damaged cord or plug. Contact Customer Service or Service Center for the repair or replacement of the line cord.
- 4 DO NOT use if the appliance is not working, has been dropped, dropped into water, damaged or left outdoors.
- 5 NO SERVICEABLE PARTS. Incorrect re-assembly or repair can cause a risk of electrical shock or injury to persons when the appliance is used. Contact Customer care.
- 6 The hose contains electrical wires. Do not use when damaged, cut or punctured.
- 7 DO NOT pull or carry vacuum cleaner by the cord or use the cord as a handle.
- 8 DO NOT unplug by pulling on cord; to unplug, grasp the plug, not the cord.
- 9 DO NOT handle plug or vacuum cleaner with wet hands.
- 10 DO NOT run the vacuum cleaner over the power cord, close a door on the cord or pull cord around sharp corners.
- 11 The use of an extension cord is not recommended.
- 12 DO NOT leave vacuum cleaner unattended when plugged in.
- 13 Keep cord away from heated surfaces.
- 14 Turn off all controls before plugging or unplugging the vacuum cleaner.
- 15 Always turn off the vacuum cleaner before connecting or disconnecting power nozzle.
- 16 Store your vacuum cleaner with the power cord secured around the two cord holders.

GENERAL USE

- 17 Use only as described in this manual.
- 18 DO NOT put any objects into openings. DO NOT use with any opening blocked; keep free of dust, lint, hair, and anything that may reduce air flow.
- 19 Keep your work area well lit.
- 20 Keep the vacuum cleaner moving over the carpet surface at all times to avoid damaging the carpet fibers.
- 21 DO NOT place vacuum cleaner on unstable surfaces such as chairs or tables.
- 22 DO NOT use without dust cup and/or filters in place.
- 23 DO NOT step on, run over, or bend hose. The hose is powered by electrical wires that may be damaged as a result.

HOSE ATTACHMENTS

- 24 DO NOT use if air flow is restricted; if the air paths, the hose, or the accessories become blocked, turn the vacuum cleaner off. Remove all obstructions before you turn on the unit again.
- 25 Keep the end of the hose and accessory openings away from face and body.
- 26 Keep cleaning tools and hose suction openings away from hair, face, fingers, uncovered feet, or loose clothing.
- 27 Only use manufacturer's recommended attachments.

DUST CUP/FILTERS/ACCESSORIES

Before turning on the vacuum:

- 28 Make sure that all filters are thoroughly dry after routine cleaning.
- 29 Make sure that dust cup and all filters are in place after routine maintenance.
- 30 Make sure accessories are free of blockages.
- 31 Use only manufacturer's recommended accessories and replacement parts.

GENERAL CLEANING

- 32 DO NOT pick up large-sized objects.
- 33 DO NOT pick up hard or sharp objects such as glass, nails, screws or coins that could damage the vacuum cleaner.
- 34 DO NOT pick up smoking or burning objects such as hot coals, cigarette butts, or matches.
- 35 DO NOT pick up flammable or combustible materials such as lighter fluid, gasoline, or kerosene or use vacuum in areas where they may be present.
- 36 DO NOT pick up toxic solutions such as chlorine bleach, ammonia, or drain cleaner.
- 37 DO NOT use in an enclosed space where vapors are present from paint, paint thinner, moth-proofing substances, flammable dust or other explosive or toxic materials.
- 38 DO NOT vacuum up any liquids.
- 39 DO NOT immerse vacuum cleaner in water or other liquids.
- 40 DO NOT use outdoors or on wet surfaces; use only on dry surfaces.
- 41 Use extra care when cleaning on stairs.

SAVE THESE INSTRUCTIONS

FOR HOUSEHOLD USE ONLY



NZ: 0800 002 999

ASSEMBLY

- 1 Place the nozzle on the floor and insert the wand.
- 2 Insert the handle into the wand.
- 3 Slide the pod onto the wand.
- 4 Attach the hose to the back of the pod.
- 5 Insert the crevice tool and upholstery tool into the accessory clips as shown.

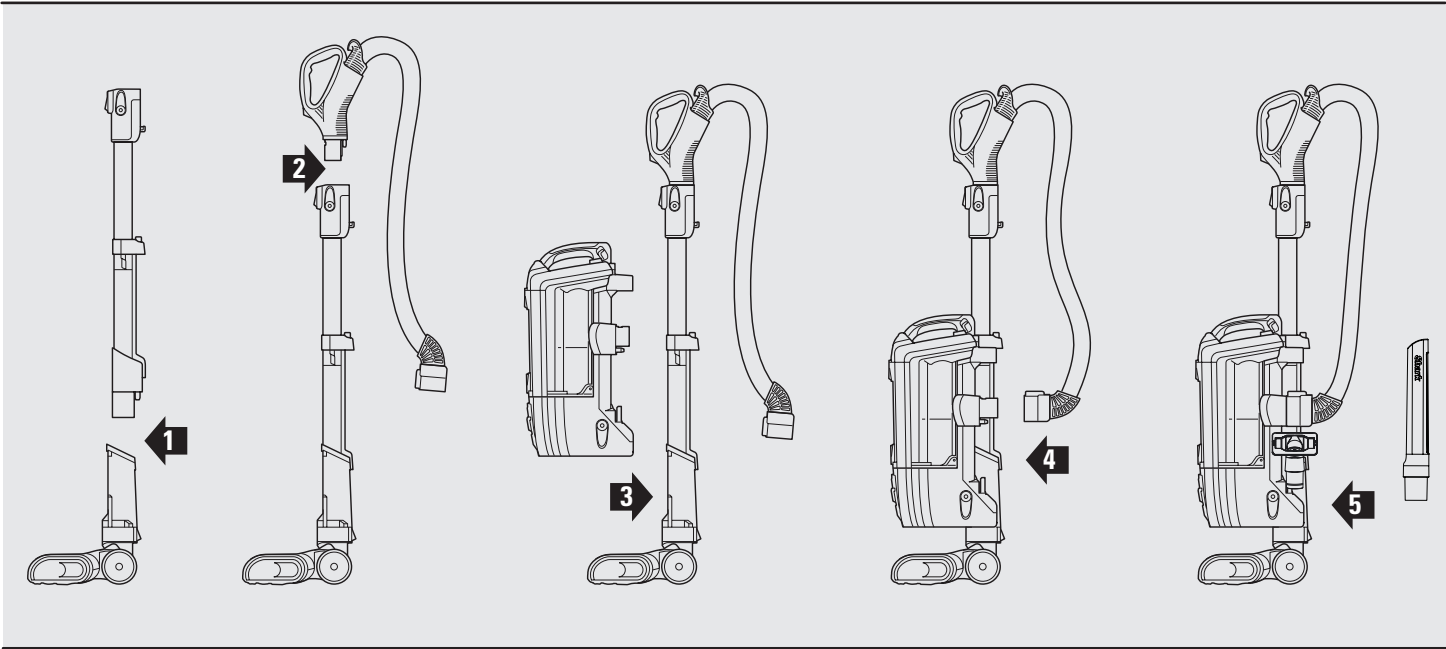

UPRIGHT  
CLEANING

- ⚠ WARNING:** To reduce the risk of electric shock, unplug the unit before assembling, adding or removing attachments or converting modes.
- ⚠ WARNING:** Always ensure the power is OFF (“O” position) before plugging and unplugging.
- 1 Press POWER and push the surface selector to THICK CARPET/AREA RUG for high piles, thick carpets, area rugs, and specialty carpets. This setting produces reduced suction with the motorized brush roll. It is the best setting if the vacuum becomes difficult to push or pull due to high suction.
- 2 Press POWER and push the surface selector to CARPET/LOW PILE for low pile and normal carpet types. This is the default carpet setting and produces high suction with the motorized brush roll.
- 3 Press POWER and push the surface selector to HARD FLOOR for hard floors and accessories. This setting produces high suction and turns off the motorized brush roll.
- 4 Place your left foot gently on the floor nozzle and tilt the handle back to start cleaning. Note: The motorized brushroll will only spin once the vacuum is reclined back.

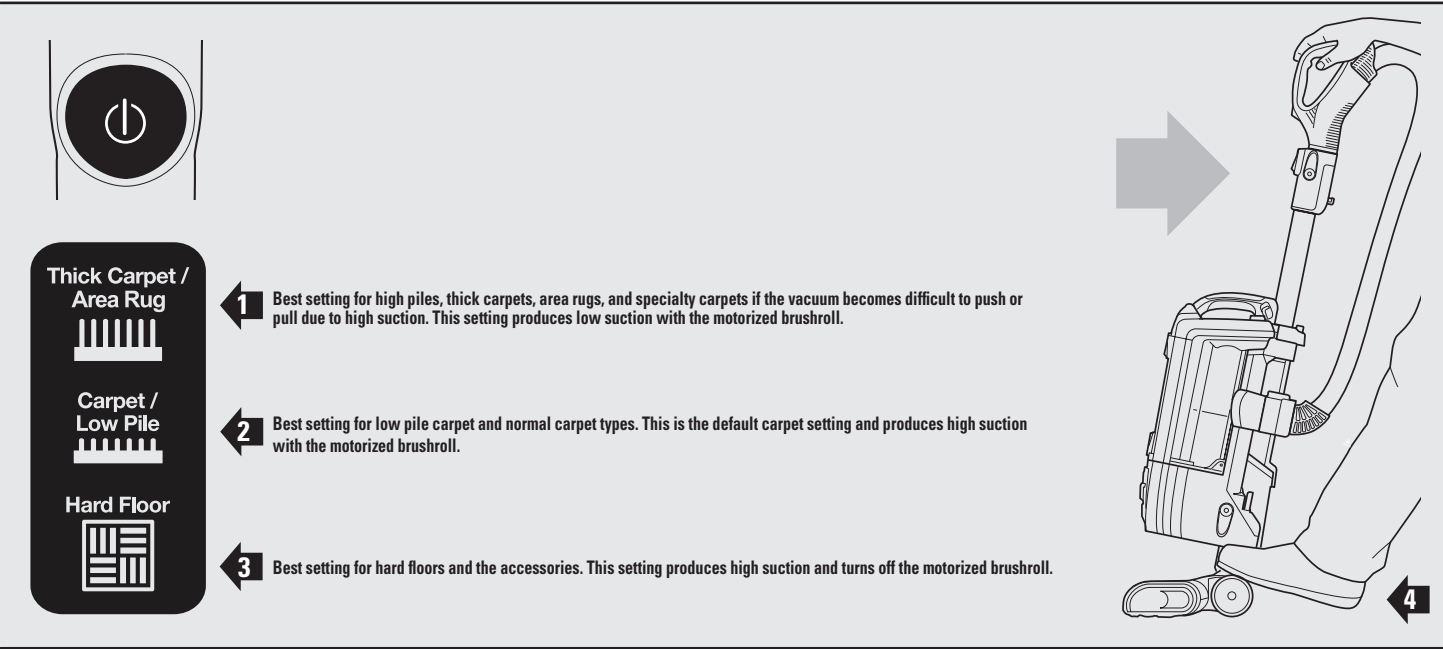

- ABOVE FLOOR  
CLEANING
- 5

To clean with the hose, press the WAND or HANDLE release button (depending on the amount of reach required) then lift handle up.
- 6

Insert wand or handle directly into desired tool.

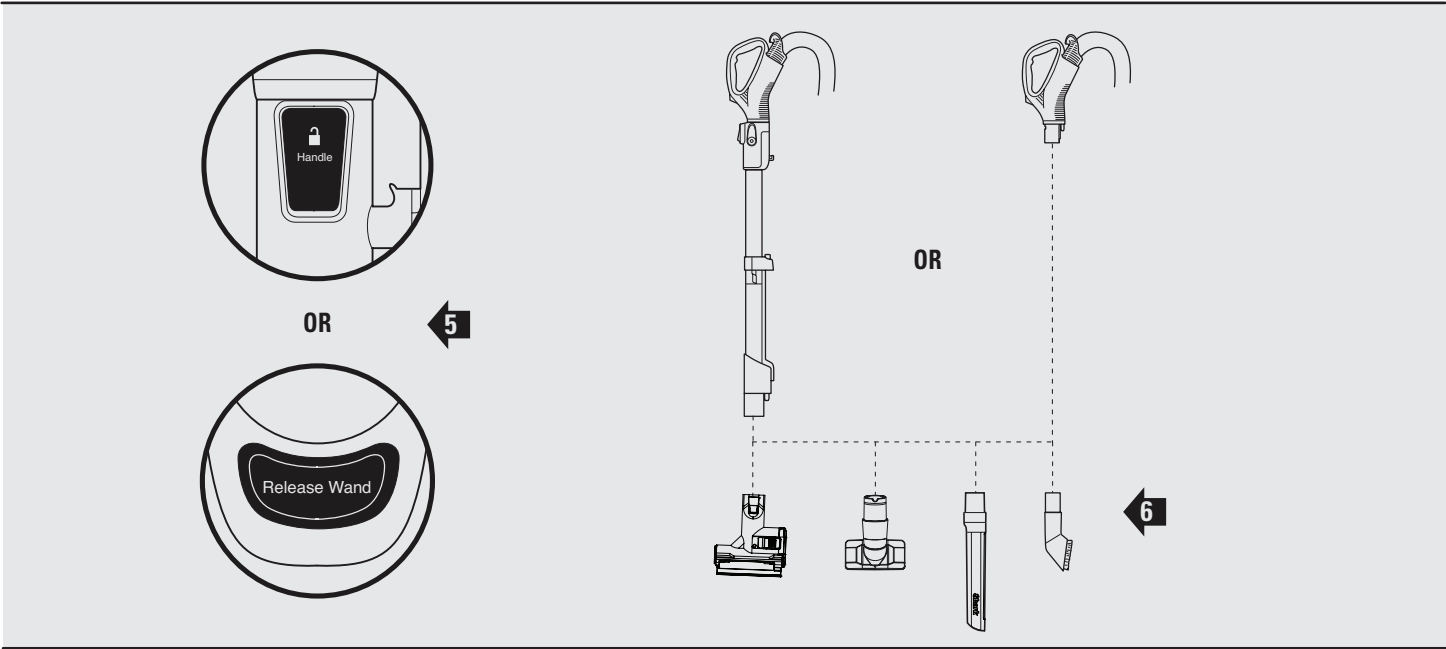

- LIFT-AWAY™  
CLEANING
- 1

Press LIFT-AWAY™ to lift the pod off the wand.
- 2

To clean with hose, press the WAND or HANDLE release button then lift handle up.
- 3

Attach desired cleaning tool.
- 4

For best suction, push the surface selector to HARD FLOOR setting.
- NOTE:

Select cleaning accessories are included with this model. Additional accessories are available for purchase.  
For a list of what is included with this model, refer to inside flap of box.

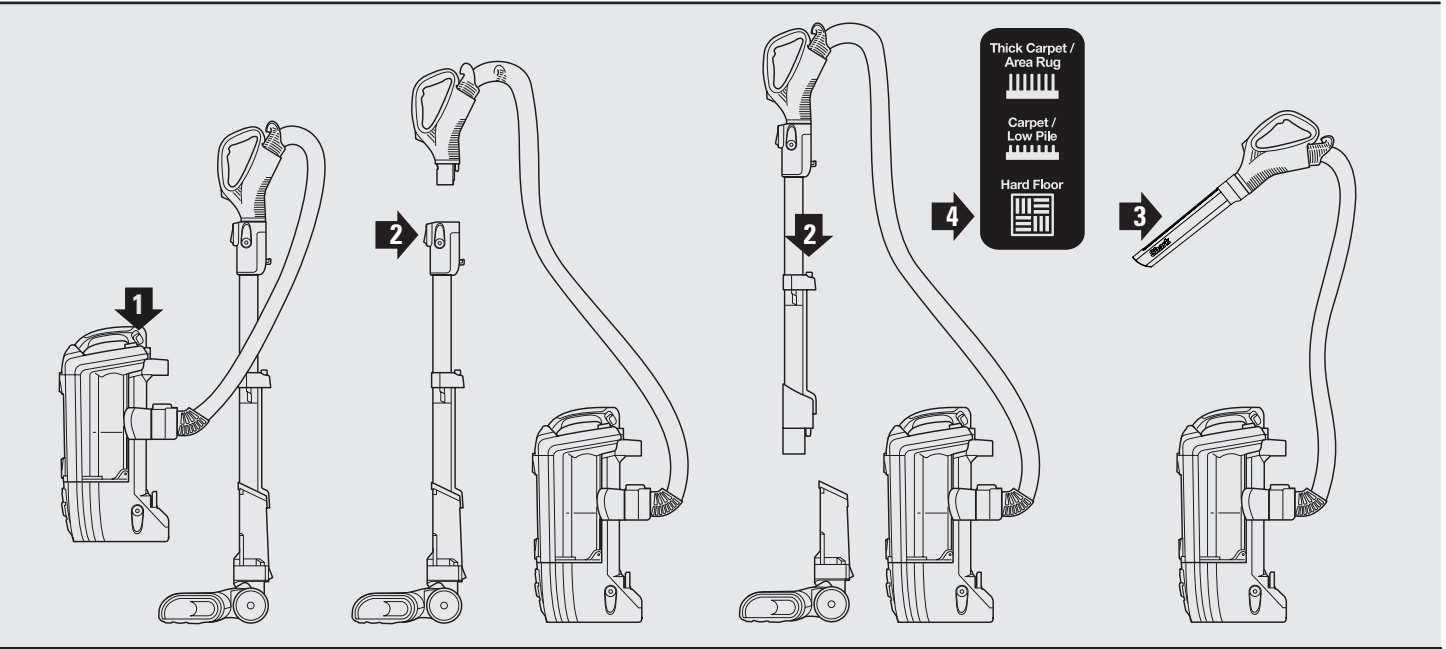

ACCESSORIES

NOTE: Select cleaning accessories are included. Others are available for purchase.

For a list of what is included with this model, refer to inside flap of box.

**28 cm Crevice Tool**  
**161FLI650**

For accessing hard to reach places.

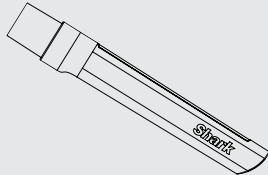

**Upholstery Tool**  
**159FLI650**

Designed for removal of ground-in dirt.

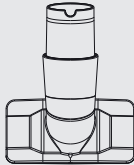

**True Pet Mini Motorised Brush**  
**3115NV220**

Picks up pet hair, loose debris, and powerfully deep cleans dander out of upholstery and surfaces.

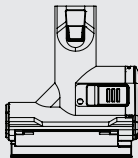

**Dusting Brush**  
**134FLI480**

Cleans hard surfaces and upholstery.



HELPFUL TIPS

POWER BUTTON

- 1 The POWER button turns the vacuum on.

SURFACE SELECTOR

- 2 Selecting the Hard Floor setting will stop the brushroll from spinning and allow you to clean bare floor and above floor surfaces with ease. Thick Carpet/Area Rug and Carpet/Low Pile settings refer to the strength of the suction power. "Carpet/Low Pile" is the default carpet setting and gives you the greatest suction and deep cleaning power. "Thick Carpet/Area Rug" deep cleans higher pile, thicker carpets, specialty carpets, and area rugs with less suction. If the vacuum is difficult to push or pull on certain carpets or area rugs, you can either disengage the brush roll and use the suction only setting or switch the surface selector to Thick Carpet/ Area Rug mode.

CORD HOOKS

- 3 For quick cord access, rotate upper hook 180° and remove cord. Rotate it back for cord storage.

HEADLIGHTS

- 4 The Illuminozzle is designed to illuminate debris in dark areas, the headlights illuminate any time the power is on. The headlights are long-lasting and designed to last the life of the vacuum.
- The LED light on the Illuminator handle will enable you to see dark areas when using the handheld accessories.

FILTERS

- 5 Remember to clean your filters regularly under normal use. Also, for optimal performance, tap clean filters between washes as needed.

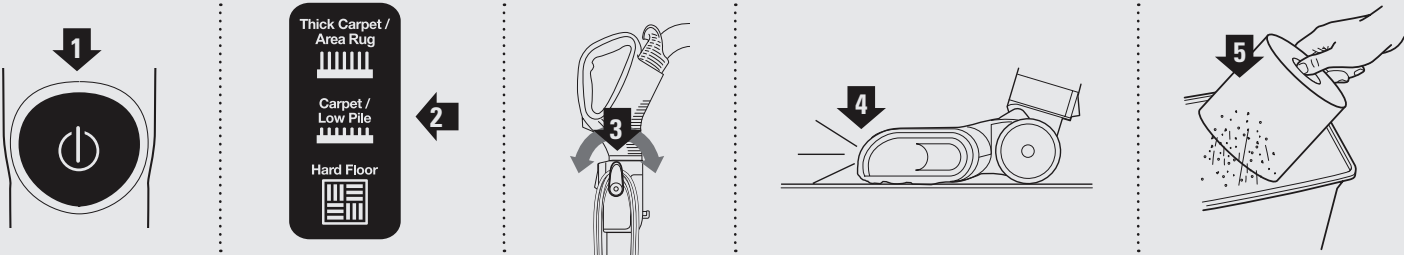

MAINTENANCE

**⚠ WARNING:** Always ensure the power is OFF (“O” position) and unplugged before cleaning your vacuum.

EMPTY THE DUST CUP

- 1 Pull up on the dust cup release latch and lift the dustcup off the pod.
- 2 Holding the dust cup over a garbage bag or can, press the bottom empty release latch.
- 3 Press the top dust cup release latch to access the dust screen and remove built-up debris as required.

CLEAN THE FILTERS  
See cleaning schedule on page 2

- 4 With the dust cup detached, remove and rinse the foam and felt filters every 3 months. Hand wash only. Let air dry completely before re-inserting. Tap loose dirt off filters between washes as needed.
- 5 Once a year, open the filter grill to remove and rinse the HEPA filter. Hand wash only. Let air dry completely before replacing.

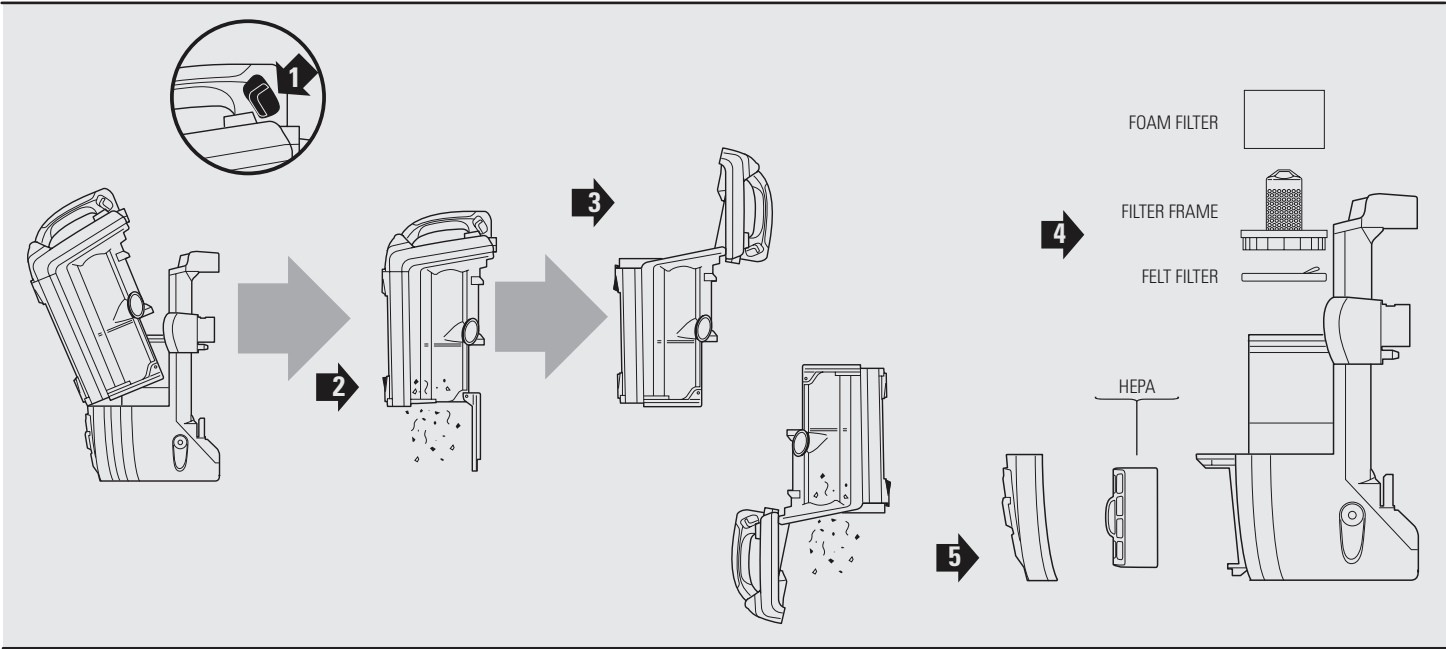

MAINTENANCE

CHECK FOR BLOCKAGES

REMOVE AND INSPECT:

- 1 **HOSE AND TUBES**  
Remove floor nozzle and extension wand and shine a flashlight up from the bottom to check for possible blockage. Remove dustcup and hose to check intake opening and hose elbow.
- 2 **BOTTOM OF FLOOR NOZZLE**
  - a Use a coin to unlock the three locks on the bottom of the floor nozzle. A portion of the base is removable to allow for better access to the brush roll and exposure to the airway. Shine a flashlight from the bottom to check for possible blockage in the airway.
  - b Remove any string, carpet fibres or hair that may be wrapped around the brush roll. There is a groove on the brush bar that allows a pair of scissors to cut across it to loosen up the debris.
  - c To reassemble, replace base by lining it up along the front of the nozzle. Push down to snap into place. Lock the three locks.

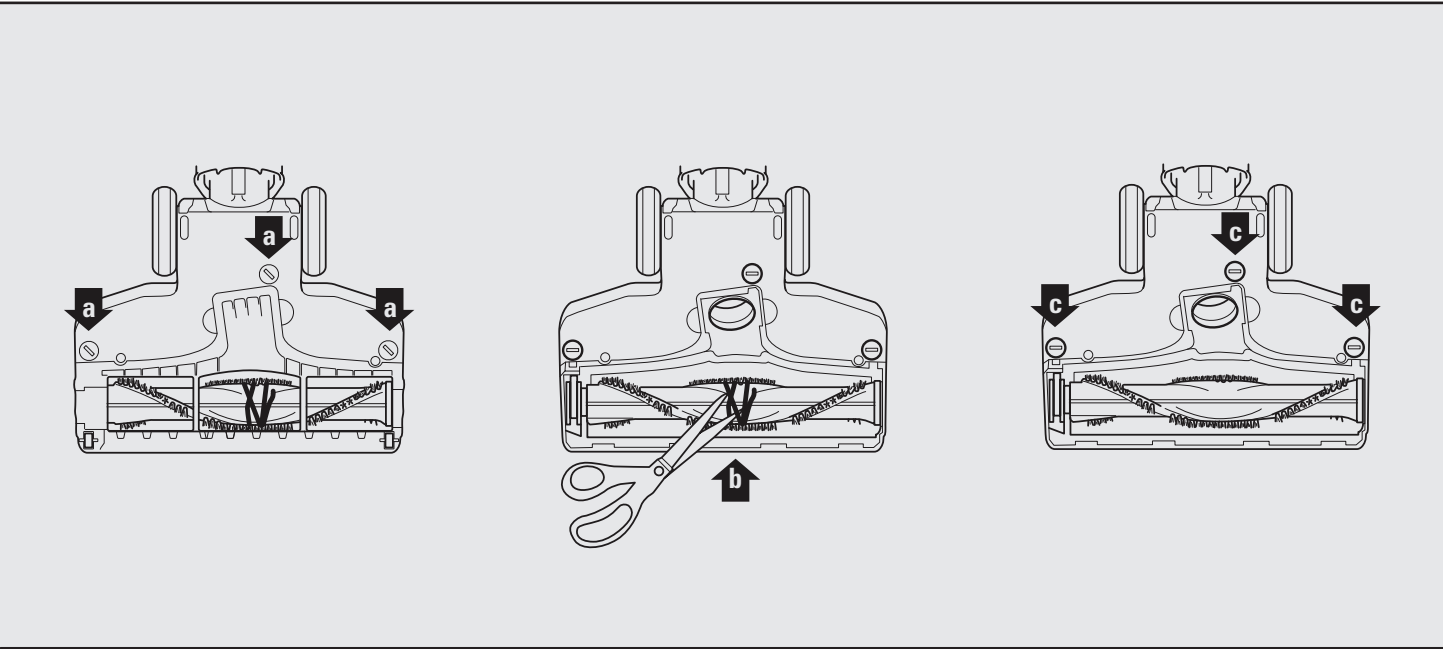

TROUBLE-  
SHOOTING  
GUIDE

Vacuum is not picking up dirt. No suction or light suction

- Check filters to see if they need cleaning. Follow instructions for rinsing and drying the filters before re-inserting back into the vacuum.
- Dust cup may be full; empty dust cup.
- Check hose, hose connections, nozzles and accessories for blockages; clear blockages if required.

Vacuum lifts area rugs

- Turn off the unit to disengage the brush roll and restart with the POWER button for suction only cleaning.

Brush roll does not spin

- Pull the handle toward you and release the floor nozzle to disengage the auto-off feature.
- Make sure that the carpet height selector is not on the HARD FLOOR setting.
- Immediately turn off and unplug vacuum, disconnect the nozzle and remove blockage before reconnecting and turning vacuum back on.

Vacuum turns off on its own

- If the hose connection is not properly latched, it can cause a poor electrical connection and the hose can come loose and power vacuum OFF.
  1. Turn the unit off; unplug the vacuum.
  2. Empty the dust cup and clean filters.
  3. Check for blockages in hose, accessories and inlet openings.
  4. Remove cord from cord hook so hose latch can be seen and engaged. Reassemble.
  5. Ensure hose latch makes an audible “click” where the hose meets the back of the vacuum. Also, make sure the hose latch makes a “click” where the wand plugs into the neck of the floor nozzle, and where the handle plugs into the wand. The connection of the back of the dust cup to the hose often requires additional force. Ensure you hear the audible click.
  6. Pull on hose to ensure latch is fully engaged.
  7. If latch is not flush to hose connector, hose is not fully engaged.
  8. Plug in the vacuum.
  9. Restart the vacuum.
- This vacuum cleaner is equipped with a motor protective thermostat. If for some reason your vacuum overheats, the thermostat will automatically turn the unit off. Should this occur, perform the following steps to restart the motor thermostat:
  1. Turn the unit off.
  2. Unplug the vacuum.
  3. Empty the dust cup and clean filters.
  4. Check for blockages in hose, accessories and inlet openings.
  5. Allow the unit to cool for a minimum of 45 minutes.
  6. Plug in the vacuum.
  7. Restart the vacuum.

Note: If vacuum still does not start, contact Customer Care at: AUST: 1800 890 840 or NZ: 0800 002 999.

NOTES



- **For New Zealand Consumers:** We will replace the product with a new product, free of charge, or repair the product at our cost, at our discretion.
- **For Australian Consumers:** Our goods come with guarantees that cannot be excluded under the Australian Consumer Law. You are entitled to a replacement or refund for a major failure and for compensation for any other reasonably foreseeable loss or damage. You are also entitled to have the goods repaired or replaced if the goods fail to be of acceptable quality and the failure does not amount to a major failure.

- **DO NOT** operate the appliance with a damaged plug or cord, or if the unit has been dropped, damaged or dropped in water. To avoid the risk of electric shock, do not disassemble or attempt to repair the appliance on your own. If the supply cord is damaged, **it must be replaced by a qualified electrician in order to avoid a hazard**. Incorrect re-assembly or repair can cause a risk of electrical shock or injury to persons when the appliance is used.

- The product has not been misused, abused, neglected, altered, modified or repaired by anyone.
- The product has been subjected to fair wear and tear.
- The product has not been used for trade, professional or hire purposes.
- The product has not sustained damage through foreign objects, substances or accident.

- Components that are subject to natural wear and tear caused by normal use in accordance with operating instructions.
- Unauthorised/improper maintenance/handling or overload is excluded from this warranty.
- For guarantee claims you will need to submit a proof of purchase in the form of a valid receipt that displays date and place of purchase.

This warranty does not apply to accessories supplied with the product.

Replacement products will be covered by the limited warranty for the balance of the warranty period from the date of the original purchase.

Only defective product or parts returned to place of purchase will be replaced under this warranty.

### Australia Contact

Brand Developers Limited  
Unit H, 686 Rosebank Road,  
Avondale 1026, Auckland, New Zealand  
FAX: +64 9 306 8203  
NZ Customer Care 0800 002 999

Brand Developers Aust Pty Ltd  
461 Plummer Street,  
PORT MELBOURNE, VIC 3207  
FAX: +61 3 9681 7825  
AUST Customer Care: 1800 890 840

**Rotator** and **Lift-Away** are trademarks of Euro-Pro Operating LLC.



# Shark®

**Distributed by:**

**Brand Developers Aust Pty Ltd**

461 Plummer Street  
PORT MELBOURNE, VIC 3207  
FAX: +61 3 9681 7825  
AUST Customer Care: 1800 890 840



**Brand Developers Ltd**

Unit H, 686 Rosebank Road,  
Avondale, 1026 Auckland,  
NEW ZEALAND  
FAX: +64 9 306 8203  
NZ Customer Care: 0800 002 999



GMA-102233-EA-009